



150 Dodd Street SE
Marietta, GA. 30060

Phone: 770-973-6251
Fax: 678-401-3854

Email: info@mgs4u.com
Website: www.mgs4u.com

Type N female to Type N female 1.125 inch Bulkhead Mount Adapter



Technical Data Sheet

This Type N female to Type N female bulkhead mount adapter is one of several thousand RF products available from Max-Gain Systems, Inc. This adapter is an in-series coaxial adapter.

This adapter is made from a Solid Brass body that is machined and plated with Nickel for superior performance and value. This Type N female to Type N female 1.125 inch bulkhead mount adapter has a Delrin dielectric and a gold plated brass center pin. Both sides provide a Type N female which accepts a Type N male which contains a gasket, for shock- / vibration-resistant and waterproof connections.

Material Specifications

Type N female to Type N female 1.125 inch Bulkhead Adapter

P/N 7318-N-A-1125

Description	Material	Plating
Center Pin	Brass	Gold
Body	Brass	Nickel
Nut	Brass	Nickel
Insulator	Delrin	White

Mechanical Specifications

Size	Dimension
Length	1.125 in (28.56 mm)
Width	0.61 in (15.5 mm)
Height	0.61 in (15.5 mm)
Weight	0.9 oz (24 g)

Environmental Specifications

Temperature	Spec
Operating Range	-65 to +165 deg C

Compliance Certifications (see product page for current documentation)

Availability Click the following link (or enter part number in the “SEARCH” bar at the top of any page of the website) to obtain additional part information including price, inventory and certifications: <https://mgs4u.com/product/type-n-female-to-type-n-female-1-125-inch-bulkhead-mount-adapter-7318-n-a-1125/>

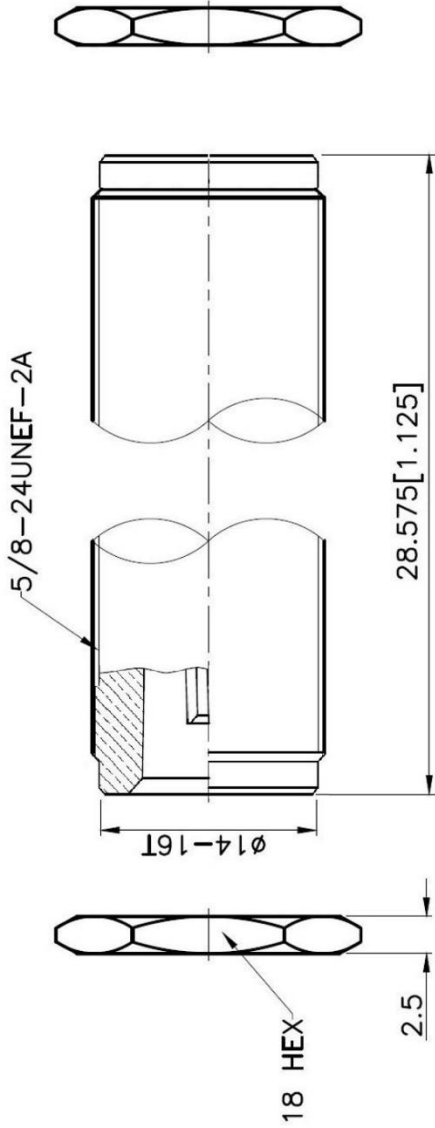

MGS MAX-GAIN SYSTEMS, INC.

Max-Gain Systems, Inc.
150 Dodd Street SE, Marietta, GA, 30060
Phone: (770) 973-6251 | Fax: (678) 401-3854
Website: www.mgs4u.com | E-Mail: sales@mgs4u.com

Type N female to Type N female 1.125 inch
Bulkhead Mount Adapter
DRAWING NO: 7318-N-A-1125
CAGE CODE: 7JZZ8

PART NO		DATE	
APPROVED		DATE	
CHECKED		DATE	
DRAWN		DATE	
UNLESS OTHERWISE SPECIFIED TOLERANCES		UNIT: mm	
0.5-5 = ±0.2		SCALE: -	
5-30 = ±0.4			
30-120 = ±0.6			
120-315 = ±1			
315-1000 = ±1.6			
1000-2000 = ±2.4			
NUT	BRASS	NICKEL	
PIN	BRASS	GOLD	
INSULATOR	DELIN	WHITE	
BODY	BRASS	NICKEL	
NO. DESCRIPTION	MATERIAL	FINISH	