



150 Dodd Street SE
Marietta, GA. 30060

Phone: 770-973-6251
Fax: 678-401-3854

Email: info@mgs4u.com
Website: www.mgs4u.com

BNC female to RP-TNC male Adapter



Technical Data Sheet

This BNC female to RP-TNC male adapter is one of several thousand RF products available from Max-Gain Systems, Inc. This adapter is a between series coaxial adapter.

This adapter is made from a Solid Brass body that is precision machined and plated with Nickel for superior performance and value. This BNC female to RP-TNC male adapter has a Delrin dielectric and a gold plated brass center pin. The BNC female side provides tabs or “bayonets” for quick and reliable connections and disconnections. The RP-TNC male side provides the jack that is normally found in a TNC female connection and internal threads, RP-TNC connections are popular in wireless and Wi-Fi applications.

Material Specifications

BNC female to RP-TNC male Adapter

Part Number 8601

Description	Material	Plating
Insulator	Delrin	White
Shell	Brass	Nickel
Pin	Brass	Gold
Insulator	Delrin	White
Body	Brass	Nickel

Mechanical Specifications

Size	Dimension
Length	1.10 in (28 mm)
Width	0.57 in (14.5 mm)
Height	0.57 in (14.5 mm)
Weight	0.5 oz (14 g)

Environmental Specifications

Temperature	Spec
Operating Range	-65 to +165 deg C

Compliance Certifications (see product page for current documentation)

Availability Click the following link (or enter part number in the “SEARCH” bar at the top of any page of the website) to obtain additional part information including price, inventory and certifications: <https://mgs4u.com/product/bnc-female-to-rp-tnc-male-adapter-8601/>

7/16-28UNEF-2B

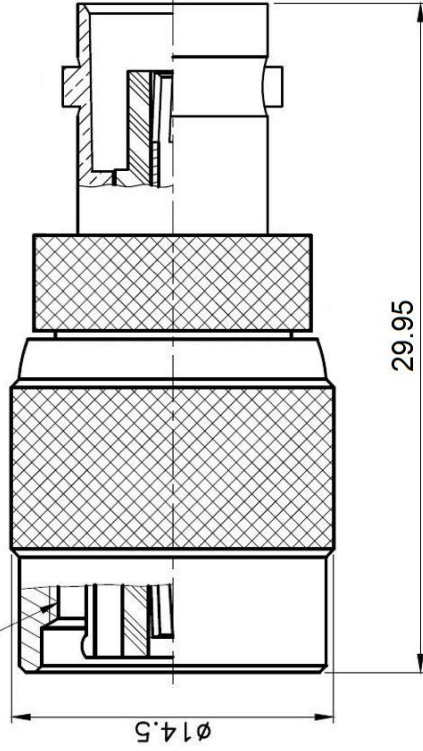

MGS MAX-GAIN SYSTEMS, INC.

Max-Gain Systems, Inc.
 150 Dodd Street SE, Marietta, GA, 30060
 Phone: (770) 973-6251 | Fax: (678) 401-3854
 Website: www.mgs4u.com | E-Mail: sales@mgs4u.com

TITLE: BNC female to RP-TNC male Adapter

DRAWING NO: 8601

FILE NO :

		PART NO	DATE
		APPROVED	DATE
		CHECKED	DATE
		DRAWN	DATE
UNLESS OTHERWISE SPECIFIED TOLERANCES			
0.5-5 = ±0.2			
5-30 = ±0.4			
30-120 = ±0.6			
120-315 = ±1			
315-1000 = ±1.6			
1000-2000 = ±2.4			
UNIT: mm			
SCALE: .			
SHELL	BRASS	NICKEL	
PIN	BRASS	GOLD	
INSULATOR BODY	DELTRIN	WHITE	
NO. DESCRIPTION	BRASS	NICKEL	
	MATERIAL	FINISH	