



150 Dodd Street SE
Marietta, GA. 30060

Phone: 770-973-6251
Fax: 678-401-3854

Email: info@mgs4u.com
Website: www.mgs4u.com

RP-SMA male, Crimp-On, Cable End Connector for RG-11, RG-213, RG-213/U, RG-393, RG-393/U, RG-8, RG-8/U, RG-8A, RG-83, LMR-400, LMR-400 Ultraflex, Belden 7810A, Belden 8216, Belden 83269, Belden 83284, Belden 84316, and other 0.390 and 0.405 Inch OD Coax.



Technical Data Sheet

This RP-SMA Male Crimp Connector is one of several thousand RF products available from Max-Gain Systems, Inc.

This connector is made from a Solid Brass body that is precision machined and plated with Gold for superior performance and value. This RP-SMA Male Crimp Connector has a PTFE dielectric and a gold plated brass center pin. The RP-SMA Male interface provides the same threads as an SMA male and pins that are normally found in SMA female connections; RP-SMA connections are popular in Wi-Fi, WiMAX, and other computer applications. This RF connector fits (but not limited to) RG-11, RG-213, RG-213/U, RG-393, RG-393/U, RG-8, RG-8/U, RG-8A, RG-83, LMR-400, LMR-400 Ultraflex, Belden 7810A, Belden 8216, Belden 83269, Belden 83284, Belden 84316, and other 0.39 and 0.405 Inch OD Coax.

Material Specifications

RP-SMA male, Crimp-On, Cable End Connector Coax

Part Number 8895-RPSMA-400

Description	Material	Plating
Ferrule	Brass	Gold
Pin	Phosphor Bronze	Gold
Shell	Brass	Gold
C Ring	Steel	None
Gasket	Rubber	Red
Insulator	Teflon	White
Body	Brass	Gold

Mechanical Specifications

Size	Dimension
Length	1.01 in (25.8 mm)
Width	0.48 in (12 mm)
Height	0.48 in (12 mm)
Weight	0.3 oz (10 g)

Environmental Specifications

Temperature	Spec
Operating Range	-65 to +165 deg C

Compliance Certifications (see product page for current documentation)

Availability Click the following link (or enter part number in the “SEARCH” bar at the top of any page of the website) to obtain additional part information including price, inventory and certifications: <https://mgs4u.com/product/rp-sma-male-crimp-connector-for-0-405-inch-od-coax-8895-rpsma-400/>

1/4-36UNS-2B

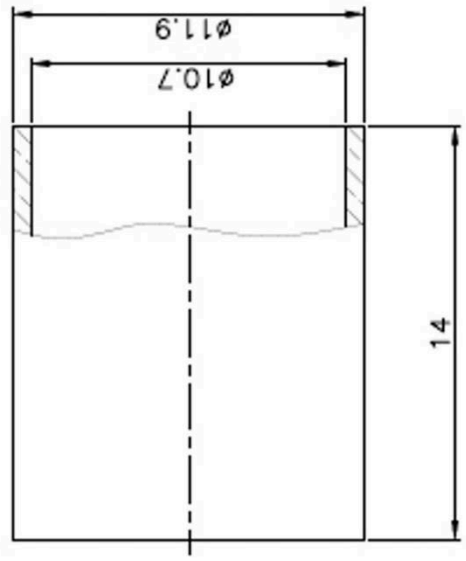
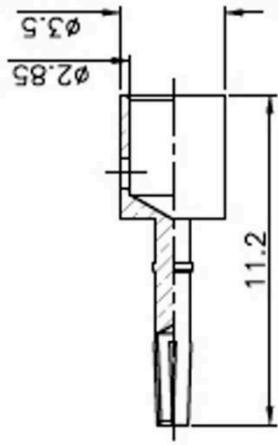
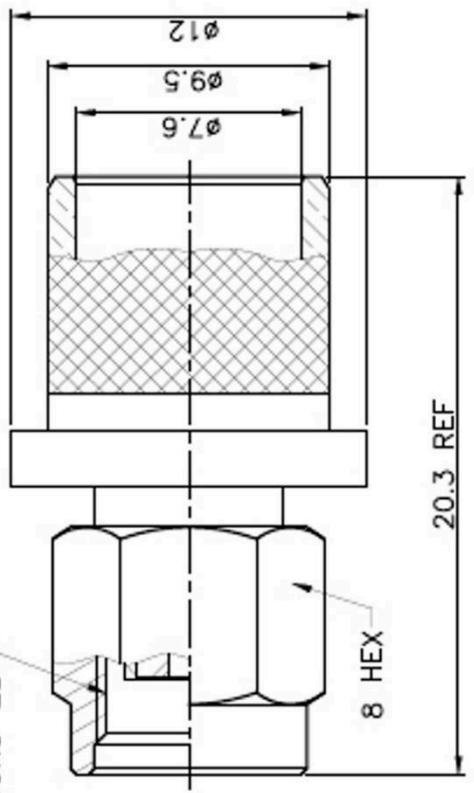

.429"

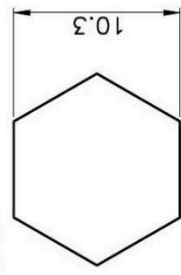

.128"

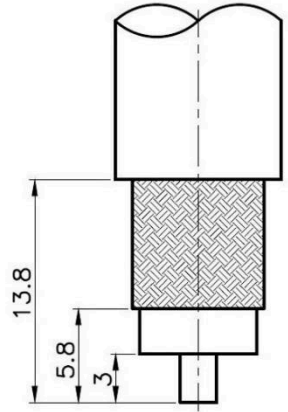
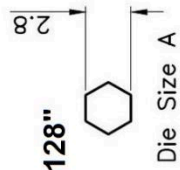

RECOMMENDED
CABLE STRIPPING DIM'S

MGS MAX-GAIN SYSTEMS, INC.

Max-Gain Systems, Inc.
150 Dodd Street SE, Marietta, GA, 30060
Phone: (770) 973-6251 | Fax: (678) 401-3854
Website: www.mgs4u.com | E-Mail: sales@mgs4u.com

TITLE: RP-SMA Male Crimp Connector 0.405
Inch OD Coax

DRAWING NO: 8895-RPSMA-400
FILE NO :

NO.	DESCRIPTION	MATERIAL	FINISH	QTY	UNLESS OTHERWISE SPECIFIED TOLERANCES		PART NO	DATE
	FERRULE	BRASS	GOLD	1	0.5-5	±0.2	APPROVED	DATE
	PIN	PHOSPHOR BRONZE	GOLD	1	5-30	±0.4	CHECKED	DATE
	SHELL	BRASS	GOLD	1	30-120	±0.6	DRAWN	DATE
	C RING	STEEL	NONE	1	120-315	±1		
	GASKET	RUBBER	RED	1	315-1000	±1.6		
	INSULATOR	TEFLON	WHITE	1	1000-2000	±2.4		
	BODY	BRASS	GOLD	1	UNIT: mm			
	NO. DESCRIPTION	MATERIAL	FINISH	QTY	SCALE: .			

Installation Guide

We will begin by installing the RP-SMA male crimp-on connector on a piece of coax. This process is the same for all the types of coaxial cable that fit this RP-SMA male crimp-on connector. These connectors fit on a wide range of coax types, including: RG-11, RG-213, RG-213/U, RG-393, RG-393/U, RG-8, RG-8/U, RG-8A, RG-83, LMR-400, LMR-400 Ultraflex, Belden 7810A, Belden 8216, Belden 83269, Belden 83284, Belden 84316, and other 0.39 and 0.405 Inch OD Coax.

Identify all connector parts (3 Parts):

Each connector consists of one body assembly (plug), one rear ferrule (crimp sleeve), and one center pin (plug contact).



Coax Stripping:

First cut your cable to the desired length and then strip the black jacket back approximately 0.54 inches. When the jacket is stripped cut the braid/foil back 0.23 inches from the fresh cut end. Finally, cut back the dielectric 0.12 inches from the fresh end down to the center conductor. The braid needs to be cut back further than the dielectric to insure that none of the braid or foil is touching the center conductor which could cause a short.

Note: Do not nick the braid, dielectric, and center conductor if at all possible. Tinning of the center conductor is not necessary if contact is to be crimped. For solder method, tin the center conductor if the center is stranded. twist the center conductor very tightly prior to tinning.

Step 1

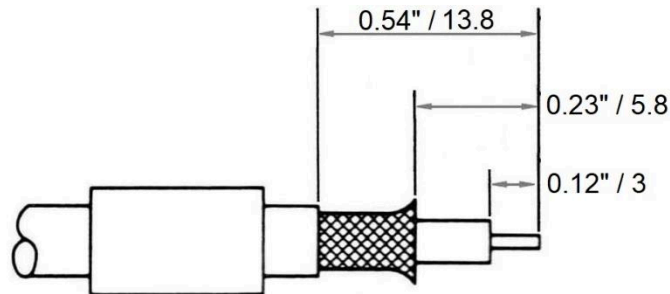

Install Method Selection:

Slide the outer ferrule onto the coax as shown below. Flare the braid slightly to allow insertion of the connector main body. Important: Do not comb out braid.

Place the center contact on the center conductor of the coax so that it butts against the cable dielectric. The center conductor should be visible through the solder / inspection hole of the contact. Crimp or solder contact in place as follows:

Crimp-on Method

Use the 7505-DIE-400 with a hex of 0.128 and 0.10 installed into a 7505-HANDLE Ratcheting crimp handle for the center pin. Start by using the large hex of 0.128 on the pin crimp location. depending on the coax being used, you may need to use the 0.10 hex in order make a secure connection. (DO NOT OVER CRIMP / CRUSH THE CENTER CONDUCTOR)

Solder-On Method

Make sure the solder hole is facing up. Touch the soldering iron to the underside of the center pin directly under the solder hole. Touch the solder to the center conductor through the solder hole on the center pin. Allow the heat from the metal to melt the solder so that it wicks into the center pin. Once the solder melts it only takes a tiny amount of solder to make the connection. Do not allow the solder to pool over the solder hole. The outside of the center pin should be free of obstructions for insertion. Do not over heat the center pin which could cause swelling of the dielectric of the coax.

Step 2

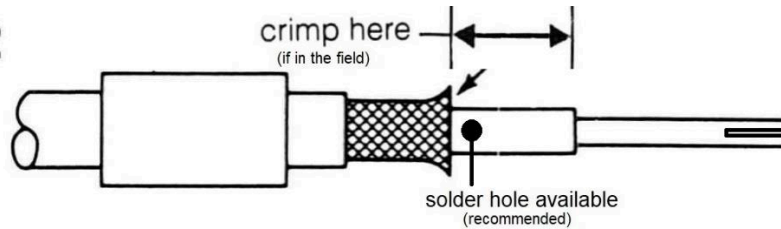

Main Body Install:

Install the cable assembly with the center pin already affixed, into the main body of the connector. The knurled portion of the main body slides under the braid of the coax. Push the cable assembly into the main body until the center pin snaps into place in the dielectric of the connector.

Slide the ferrule (placed on the coax at the beginning of Step 2) over the braid and completely up against the connector body. Using the 0.429 hex of the 7505-DIE-400 installed into the 7505-HANDLE ratcheting crimp handle, crimp the ferrule at the location shown in the picture below (on the ferrule, but right up against the main body of the connector).

Step 3

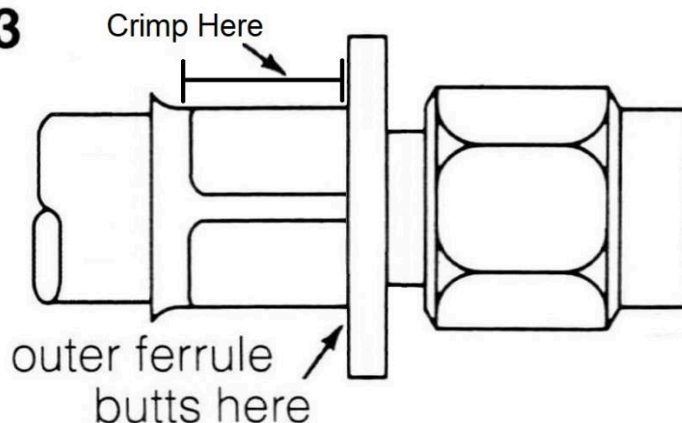

Final Testing:

When this is completed, as a final test, you should always check resistance from the center pin to the body with an ohmmeter in a low resistance scale. After verifying that there are no braid – to – center pin shorts on the other end of the coaxial cable, you should see infinite resistance (open). This completes your RP-SMA male crimp-on connector installation, and the connector is ready for use!