

CFMN-50CAC/15-AF

Old Type Designation: MC1C-50E

Specifications

Capacity C_{max} (nominal)	50 pF
Voltage (Peak Test U_{pt} / Peak Working U_{pw})	15 kV / 9 kV
Capacity Tolerance	10%
Max. Current I_{max} at 13.56 MHz with	27 Arms
Conduction Cooling	20 W
Net Weight	0.35 kg

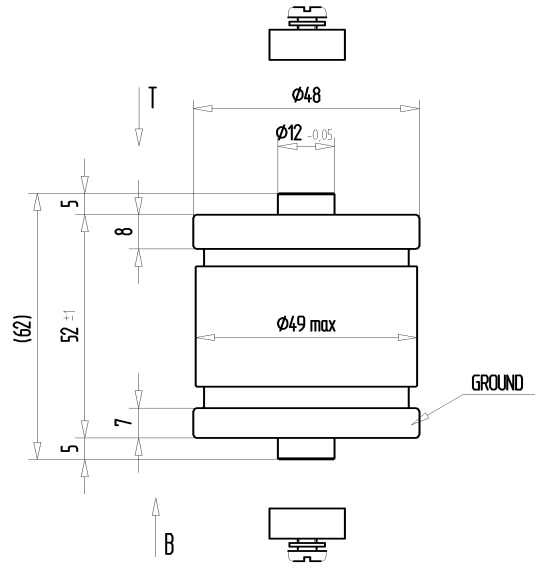

I_{max} at 25°C ambient and 125°C surface temp. for convection and conduction (20 W) cooling

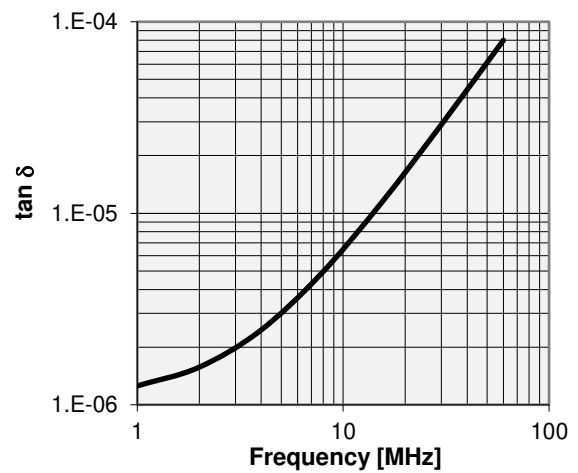
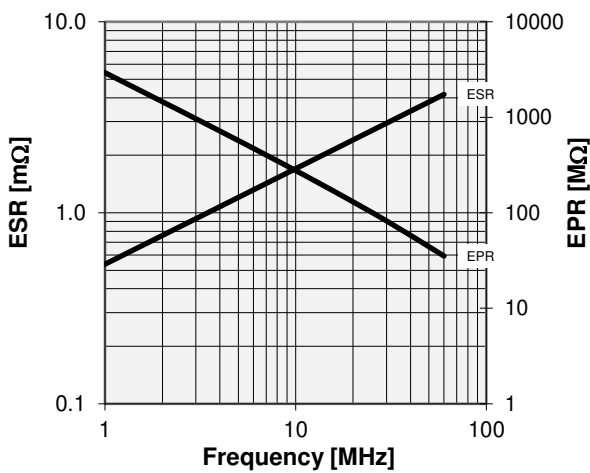
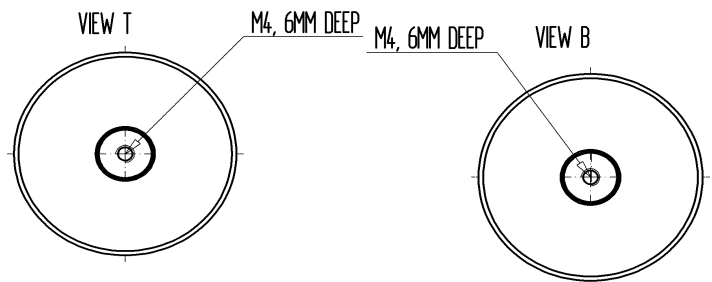
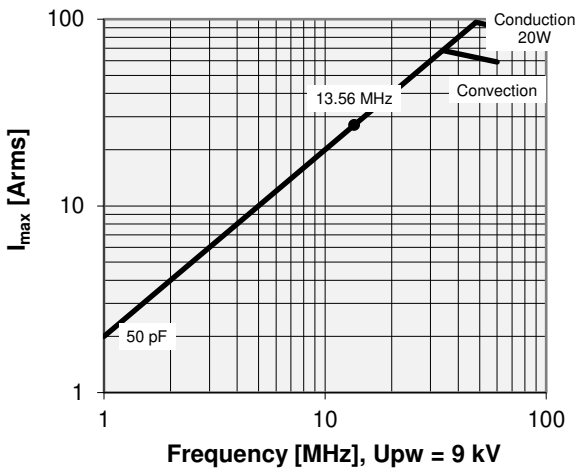

Note:
 Technical information in Service Bulletin
 SB-52 must be considered
 Subject to change without prior notice

Issue: 18-Feb-2008
 Replaces: 27-Mar-2006