



150 Dodd Street SE
Marietta, GA. 30060

Phone: 770-973-6251
Fax: 678-401-3854

Email: info@mgs4u.com
Website: www.mgs4u.com

RP-SMA female to BNC female Adapter



Technical Data Sheet

This RP-SMA female to BNC female adapter is one of several thousand RF products available from Max-Gain Systems, Inc. This adapter is a between series coaxial adapter.

This adapter is made from a Solid Brass body that is precision machined and plated with Nickel for superior performance and value. This RP-SMA female to BNC female adapter has a PTFE dielectric and a gold plated brass center pin. This RP-SMA female to BNC female adapter has a PTFE dielectric and a gold plated brass center pin. The RP-SMA female side provides the same threads as an SMA female and pins that are normally found in SMA male connections; RP-SMA connections are popular in Wi-Fi, WiMAX, and other computer applications. The BNC female side provides tabs or “bayonets” for quick and reliable connections and disconnections.

Material Specifications

RP-SMA female to BNC female Adapter

Part Number 8506

Description	Material	Plating
Center Pin	Brass	Gold
Insulator	PTFE	White
Body	Brass	Nickel
Insulator	Delrin	White

Mechanical Specifications

Size	Dimension
Length	1.047 in (26.60 mm)
Width	0.45 in (11.5 mm)
Height	0.45 in (11.5 mm)
Weight	0.3 oz (10 g)

Environmental Specifications

Temperature	Spec
Operating Range	-65 to +165 deg C

Compliance Certifications (see product page for current documentation)

Availability Click the following link (or enter part number in the “SEARCH” bar at the top of any page of the website) to obtain additional part information including price, inventory and certifications: <https://mgs4u.com/product/rp-sma-female-to-bnc-female-adapter-8506/>

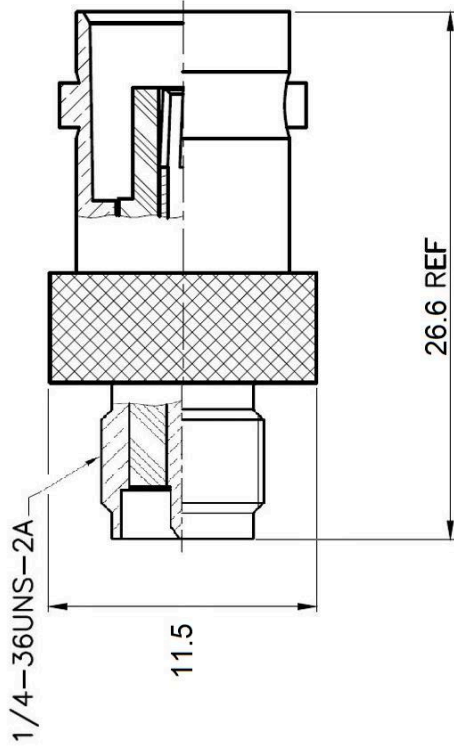

MGS MAX-GAIN SYSTEMS, INC.

Max-Gain Systems, Inc.
 150 Dodd Street SE, Marietta, GA. 30060
 Phone: (770) 973-6251 | Fax: (678) 401-3854
 Website: www.mgs4u.com | E-Mail: sales@mgs4u.com

TITLE: RP-SMA female to BNC female

DRAWING NO: 8506

FILE NO : .

		PART NO	DATE
		APPROVED	DATE
		CHECKED	DATE
		DRAWN	DATE
		UNLESS OTHERWISE SPECIFIED TOLERANCES	
		0.5-5 = ±0.2	
		5-30 = ±0.4	
		30-120 = ±0.6	
		120-315 = ±1	
		315-1000 = ±1.6	
		1000-2000 = ±2.4	
		UNIT: mm	
		SCALE: .	
INSULATOR	TEFLON	1	WHITE
PIN	BRASS	1	GOLD
INSULATOR	DELTRIN	1	WHITE
BODY	BRASS	1	NICKEL
NO. DESCRIPTION	MATERIAL	QTY	FINISH