



150 Dodd Street SE
Marietta, GA. 30060

Phone: 770-973-6251
Fax: 678-401-3854

Email: info@mgs4u.com
Website: www.mgs4u.com

BNC female to RP-SMA male Adapter



Technical Data Sheet

This BNC female to RP-SMA male adapter is one of several thousand RF products available from Max-Gain Systems, Inc. This adapter is a between series coaxial adapter.

This adapter is made from a Solid Brass body that is precision machined and plated with Nickel for superior performance and value. This BNC female to RP-SMA male adapter has a PTFE dielectric and a gold plated brass center pin. The RP-SMA male side provides the same threads as an SMA male and pins that are normally found in SMA female connections; RP-SMA connections are popular in Wi-Fi, WiMAX, and other computer applications. The BNC female side provides tabs or “bayonets” for quick and reliable connections and disconnections.

Material Specifications

BNC female to RP-SMA male Adapter

Part Number 8508

Description	Material	Plating
Center Pin	Brass	Gold
Insulator	PTFE	White
Body	Brass	Nickel
Insulator	Delrin	White

Mechanical Specifications

Size	Dimension
Length	1.083 in (27.50 mm)
Width	0.47 in (12.00 mm)
Height	0.47 in (12.00 mm)
Weight	0.3 oz (10 g)

Environmental Specifications

Temperature	Spec
Operating Range	-65 to +165 deg C

Compliance Certifications (see product page for current documentation)

Availability Click the following link (or enter part number in the “SEARCH” bar at the top of any page of the website) to obtain additional part information including price, inventory and certifications: <https://mgs4u.com/product/bnc-female-to-rp-sma-male-adapter-8508/>

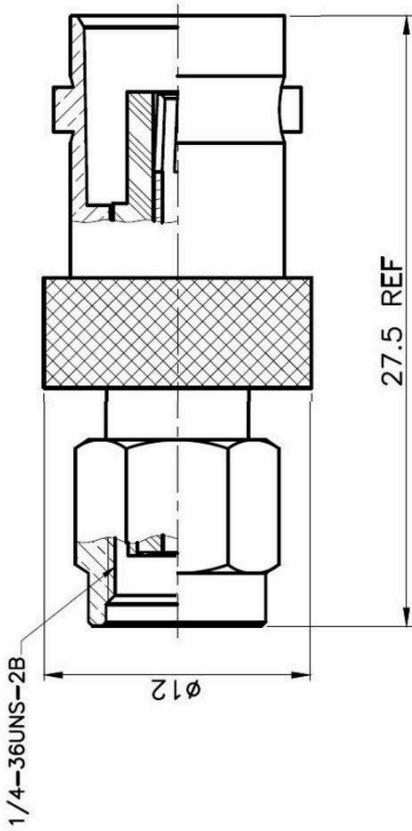

Max-Gain Systems, Inc.
 150 Dodd Street SE, Marietta, GA. 30060
 Phone: (770) 973-6251 | Fax: (678) 401-3854
 Website: www.mgs4u.com | E-Mail: sales@mgs4u.com

TITLE: BNC female to RP-SMA male
 DRAWING NO: 8508
 FILE NO : .

		PART NO		DATE	
		APPROVED		DATE	
		CHECKED		DATE	
		DRAWN		DATE	
		UNLESS OTHERWISE SPECIFIED TOLERANCES		UNIT: mm	
		0.5-5 = ±0.2		SCALE: .	
		5-30 = ±0.4			
		30-120 = ±0.6			
		120-315 = ±1			
		315-1000 = ±1.6			
		1000-2000 = ±2.4			
INSULATOR	TEFLON	WHITE			
PIN	BRASS	GOLD			
INSULATOR	DELTRIN	WHITE			
BODY	BRASS	NICKEL			
NO. DESCRIPTION	MATERIAL	FINISH			