



150 Dodd Street SE
Marietta, GA. 30060

Phone: 770-973-6251
Fax: 678-401-3854

Email: info@mgs4u.com
Website: www.mgs4u.com

SMA male to SMA female Extension Adapter



Technical Data Sheet

This SMA male to SMA female extension adapter is one of several thousand RF products available from Max-Gain Systems, Inc. This adapter is an in-series coaxial extension adapter.

This extension adapter is made from a Solid Brass body that is precision machined and plated with Gold for superior performance and value. This SMA male to SMA female extension adapter has a PTFE dielectric and a gold plated brass center pin. The SMA male side's plug and interior threads provide a sub-miniature and tight-locking connection for use at higher frequencies. The SMA female side's jack and exterior threads provide a sub-miniature and tight-locking connection for use at higher frequencies.

Material Specifications

SMA male to SMA female Extension Adapter

Part Number 7845

Description	Material	Plating
Shell	Brass	Gold
Gasket	Silicone	Red
Inner Retaining Ring	Stainless	
Insulator	PTFE	White
Center Pin	Phosphor Bronze	Gold
SMA male	Brass	Gold
Insulator	PTFE	White
SMA female	Brass	Gold

Mechanical Specifications

Size	Dimension
Length	0.68 in (17.4 mm)
Width	0.315 in (8 mm)
Height	0.315 in (8 mm)
Weight	0.1 oz (2 g)

Environmental Specifications

Temperature	Spec
Operating Range	-65 to +165 deg C

Compliance Certifications (see product page for current documentation)

Availability Click the following link (or enter part number in the “SEARCH” bar at the top of any page of the website) to obtain additional part information including price, inventory and certifications: <https://mgs4u.com/product/sma-male-to-sma-female-extension-adapter-7845/?v=7516fd43adaa>

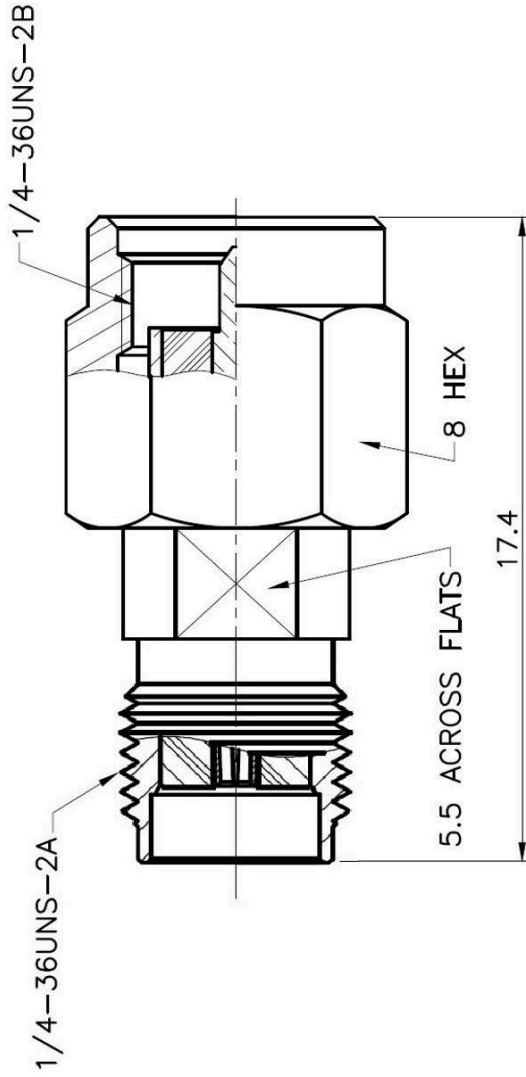

MGS MAX-GAIN SYSTEMS, INC.

Max-Gain Systems, Inc.
 150 Dodd Street SE, Marietta, GA, 30060
 Phone: (770) 973-6251 | Fax: (678) 401-3854
 Website: www.mgs4u.com | E-Mail: sales@mgs4u.com

TITLE: SMA male to SMA female Extension Adapter

DRAWING NO: 7845

FILE NO :

		PART NO	DATE
		APPROVED	DATE
		CHECKED	DATE
		DRAWN	DATE
		UNIT: mm	
		SCALE: -	
		UNLESS OTHERWISE SPECIFIED TOLERANCES	
		0.5-5 = ±0.2	
		5-30 = ±0.4	
		30-120 = ±0.6	
		120-315 = ±1	
		315-1000 = ±1.6	
		1000-2000 = ±2.4	
NO.	DESCRIPTION	MATERIAL	QTY
	GASKET	SILICONE	RED
	CONTACT PIN	BRASS	GOLD
	INSULATOR	TEFLON	WHITE
	BODY	BRASS	GOLD
		MATERIAL	FINISH