



150 Dodd Street SE
Marietta, GA. 30060

Phone: 770-973-6251
Fax: 678-401-3854

Email: info@mgs4u.com
Website: www.mgs4u.com

SMA male to BNC female Adapter



Technical Data Sheet

This SMA male to BNC female adapter is one of several thousand RF products available from Max-Gain Systems, Inc. This adapter is a between series coaxial adapter.

This adapter is made from a Solid Brass body that is precision machined and plated with Nickel for superior performance and value. This SMA male to BNC female adapter has a PTFE dielectric and a gold plated brass center pin. The SMA male side's plug and interior threads provide a sub-miniature and tight-locking connection for use at higher frequencies. The BNC female provides tabs or "bayonets" for quick and reliable connections and disconnections.

Material Specifications

| Type SMA male to BNC female Adapter | | Part Number 7820 |
|-------------------------------------|----------|------------------|
| Description | Material | Plating |
| Center Pin | Brass | Gold |
| Insulator | PTFE | White |
| Body | Brass | Nickel |
| Insulator | Delrin | White |

Mechanical Specifications

| Size | Dimension |
|--------|---------------------|
| Length | 1.083 in (27.50 mm) |
| Width | 0.47 in (12.00 mm) |
| Height | 0.47 in (12.00 mm) |
| Weight | 0.3 oz (10 g) |

Environmental Specifications

| Temperature | Spec |
|-----------------|-------------------|
| Operating Range | -65 to +165 deg C |

Compliance Certifications (see product page for current documentation)

Availability Click the following link (or enter part number in the “SEARCH” bar at the top of any page of the website) to obtain additional part information including price, inventory and certifications: <https://mgs4u.com/product/sma-male-to-bnc-female-adapter-7820/?v=7516fd43adaa>

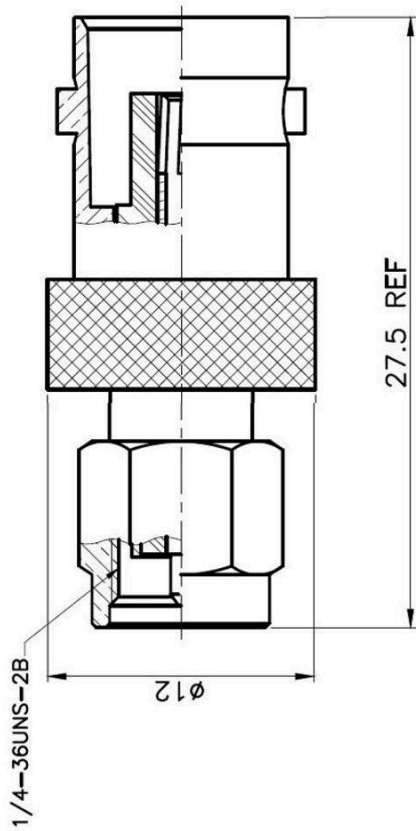

Max-Gain Systems, Inc.
 150 Dodd Street SE, Marietta, GA, 30060
 Phone: (770) 973-6251 | Fax: (678) 401-3854
 Website: www.mgs4u.com | E-Mail: sales@mgs4u.com

TITLE: SMA male to BNC female
 DRAWING NO: 7820
 FILE NO : .

| | | PART NO | DATE |
|---------------------------------------|----------|-----------|--------|
| | | APPROVED | DATE |
| | | CHECKED | DATE |
| | | DRAWN | DATE |
| UNLESS OTHERWISE SPECIFIED TOLERANCES | | | |
| 0.5-5 = ±0.2 | | | |
| 5-30 = ±0.4 | | | |
| 30-120 = ±0.6 | | | |
| 120-315 = ±1 | | | |
| 315-1000 = ±1.6 | | | |
| 1000-2000 = ±2.4 | | | |
| UNIT: mm | | | |
| SCALE: . | | | |
| NO. DESCRIPTION | MATERIAL | INSULATOR | WHITE |
| | | PIN | GOLD |
| | | INSULATOR | WHITE |
| | | BODY | NICKEL |
| | | | FINISH |