



150 Dodd Street SE
Marietta, GA. 30060

Phone: 770-973-6251
Fax: 678-401-3854

Email: info@mgs4u.com
Website: www.mgs4u.com

RP-SMA female to SMA male Adapter



Technical Data Sheet

This RP-SMA female to SMA male adapter is one of several thousand RF products available from Max-Gain Systems, Inc. This adapter is a between series coaxial adapter.

This adapter is made from a Solid Brass body that is precision machined and plated with Gold for superior performance and value. This RP-SMA female to SMA male adapter has a PTFE dielectric and a gold plated brass center pin. The RP-SMA female side provides the same threads as an SMA female and pins that are normally found in SMA male connections; RP-SMA connections are popular in Wi-Fi, WiMAX, and other computer applications. The SMA male side provides the pin in the sub-miniature, threaded, and tight-locking SMA connection type.

Material Specifications

RP-SMA female to SMA male Adapter

Part Number 8503

Description	Material	Plating
Center Pin	Brass	Gold
Insulator	PTFE	White
Body	Brass	Gold
Gasket	Silicone	Red

Mechanical Specifications

Size	Dimension
Length	0.68 in (17.4 mm)
Width	0.315 in (8 mm)
Height	0.315 in (8 mm)
Weight	0.1 oz (3 g)

Environmental Specifications

Temperature	Spec
Operating Range	-65 to +165 deg C

Compliance Certifications (see product page for current documentation)

Availability Click the following link (or enter part number in the “SEARCH” bar at the top of any page of the website) to obtain additional part information including price, inventory and certifications: <https://mgs4u.com/product/rp-sma-female-to-sma-male-adapter-8503/?v=7516fd43adaa>

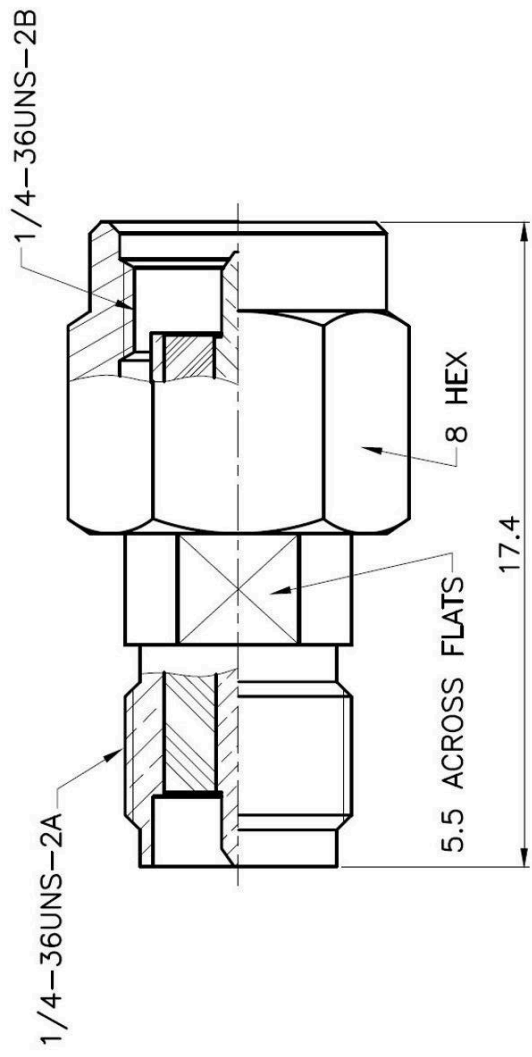

Max-Gain Systems, Inc.
 150 Dodd Street SE, Marietta, GA, 30060
 Phone: (770) 973-6251 | Fax: (678) 401-3854
 Website: www.mgs4u.com | E-Mail: sales@mgs4u.com

TITLE: RP-SMA female to SMA male Adapter
 DRAWING NO: 8503
 FILE NO :

NO.	DESCRIPTION	MATERIAL	FINISH	QTY	UNLESS OTHERWISE SPECIFIED TOLERANCES		PART NO	DATE
					0.5-5	±0.2		
					5-30	±0.4		
					30-120	±0.6		
					120-315	±1		
					315-1000	±1.6		
					1000-2000	±2.4		
					UNIT: mm			
					SCALE: .			
							APPROVED	DATE
							CHECKED	DATE
							DRAWN	DATE

GASKET	SILICONE	RED		
CONTACT PIN	BRASS	GOLD		
INSULATOR	TEFLON	WHITE		
BODY	BRASS	GOLD		
	MATERIAL	FINISH		